

QUALITY IRRIGATION  
PRODUCTS

2920 Airway Ave, Costa Mesa, Ca. 92626  
phone: 714.437.9600 fax: 714.437.9700



FINAL DRIVE GEARBOX



**760-U**  
HEAVY DUTY  
WHEEL BOX

Evaluation Specifications

- ▲ "NEW" External U.V. Resistant dust seals on Input and Output shafts
- ▲ Precision ground 2.5" output shaft.
- ▲ Peak Torque in excess of 100,000 In.-Lbs.
- ▲ Static load tested in excess of 145,000 In.-Lbs.
- ▲ 50:1 Ratio H.D. gear set.
- ▲ Double end 1 1/8" input shaft.
- ▲ Full cycle expansion chamber.
- ▲ Taper roller bearings.
- ▲ Special crop guard seals.
- ▲ Each gearbox filled with extreme pressure gear oil.
- ▲ High strength cast iron bolt on end caps.
- ▲ High strength steel worm and output shafts.
- ▲ Easy access oil fill.
- ▲ Input shaft guard included.
- ▲ Direct replacement for a Durst A-110.
- ▲ Dual output and input seals with external grease lube capabilities.
- ▲ Optional bronze gear.

CONTACT UMC AT [SALES@UMCPRODUCTS.COM](mailto:SALES@UMCPRODUCTS.COM)

## Dimensional Drawing

### Final Drive Gearbox

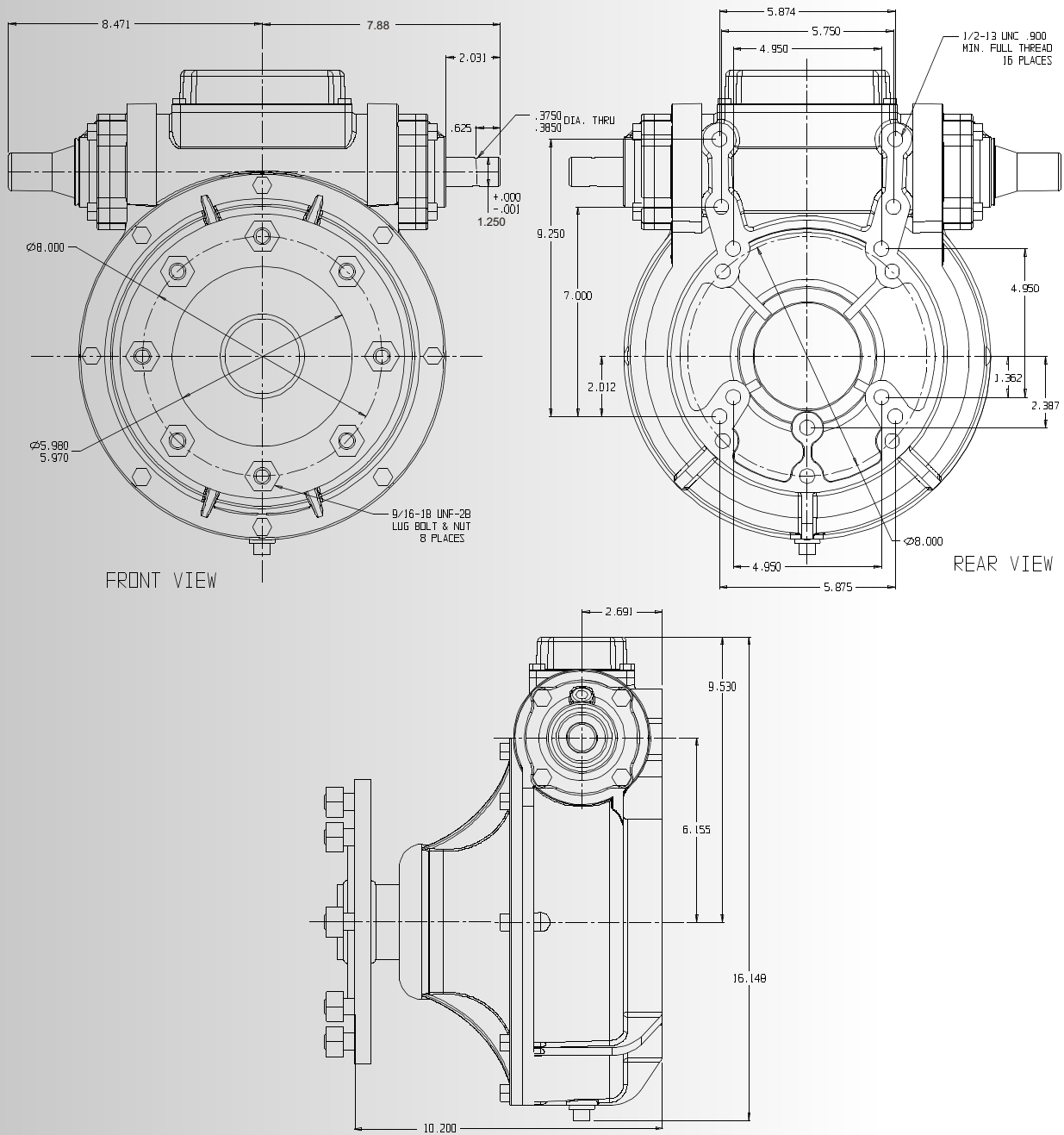

Fits most Lindsay, Valmont, Reinke, and Lockwood applications.

CONTACT UMC AT [SALES@UMCPRODUCTS.COM](mailto:SALES@UMCPRODUCTS.COM)



**Universal Motion Components, Co. Inc.**  
2920 Airway Ave, Costa Mesa, Ca. 92626  
Phone: 714.437.9600 Fax: 714.437.9700  
Web: <http://www.umcproducts.com>  
E-mail: [sales@umcproducts.com](mailto:sales@umcproducts.com)